



Diamond Premium Wet Core Bit

- Long life in cured concrete with hard aggregate and medium steel reinforcement
- Threaded cap allows for bit extension
- V-shaped turbo segment provides faster cutting action
- Designed to be used Wet
- 15" Drilling Depth



Model No.	Mfg. No.	Size	Thread	Max RPM	Price /Each.
TCR442	48-17-3007	3/4"	5/8"-11	3800	
TCR454	48-17-3009	7/8"	5/8"-11	3470	
TCR450	48-17-3010	1"	5/8"-11	3200	
TCR452	48-17-3012	1-1/4"	5/8"-11	2380	
TCR444	48-17-3015	1-1/2"	5/8"-11	2000	
TCR440	48-17-3060	6"	1-1/4"-7	550	
TCR433	48-17-3080	8"	1-1/4"-7	400	
TCR435	48-17-3100	10"	1-1/4"-7	300	
TCR432	48-17-3120	12"	1-1/4"-7	265	
TCR436	48-17-3140	14"	1-1/4"-7	225	

Diamond Ultra Dry Core Drill Bit

- Ideal for concrete, brick, and block
- Designed to be used dry
- For Use With: MX Fuel™ Core Drill and Corded Tools
- Depth of Cut: 13"
- Kerf Thickness: 3 mm
- Segment Height: 9 mm

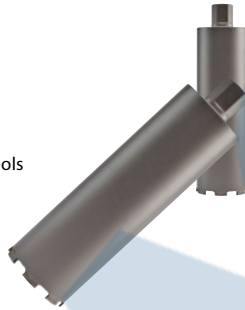

Model No.	Mfg. No.	Size	Thread	Max RPM	Price /Each.
UAI637	48-17-0112	1-1/4"	1-1/4"-7	3310	
UAI638	48-17-0120	2"	1-1/4"-7	2070	
UAI639	48-17-0125	2-1/2"	1-1/4"-7	1655	
UAI640	48-17-0130	3"	1-1/4"-7	1380	
UAI641	48-17-0135	3-1/2"	1-1/4"-7	1180	
UAI642	48-17-0140	4"	1-1/4"-7	1035	
UAI643	48-17-0150	5"	1-1/4"-7	830	
UAI644	48-17-0160	6"	1-1/4"-7	690	

Pre-Stressed Concrete Diamond Wet Core Bits

- Designed specifically for demands of drilling pre-stressed concrete
- Designed to be used Wet
- 15" Drilling Depth



Model No.	Mfg. No.	Size	Thread	Max RPM	Price /Each.
TCR428	48-17-1010	1"	5/8"-11	3200	
TCR426	48-17-1015	1-1/2"	5/8"-11	2000	
TCR453	48-17-1020	2"	1-1/4"-7	1600	
TCR438	48-17-1025	2-1/2"	1-1/4"-7	1220	
TCR431	48-17-1030	3"	1-1/4"-7	1050	
TCR451	48-17-1035	3-1/2"	1-1/4"-7	800	
TCR430	48-17-1040	4"	1-1/4"-7	800	
TCR446	48-17-1045	4-1/2"	1-1/4"-7	674	
TCR736	48-17-1050	5"	1-1/4"-7	674	
TCR434	48-17-1060	6"	1-1/4"-7	550	

Diamond Core Bit Accessories

THREADED ADAPTORS

- Reduces thread size of 1 1/4"-7 to 5/8"-11 for diamond core bits and extensions

Model No. VF172
Price/Each \$



SPACER ASSEMBLIES

- Mounts between cradle and DYMODRILL motor to increase DYMO-RIG bit capacity from 10" to 14"

Model No. VH433

For use with models TF308, TF309 and TW092

Price/Each \$

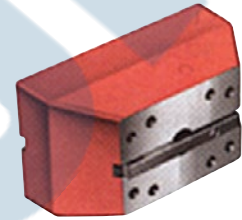

Model No. VH434

For use with models TEA016, TEA017, VH886 and VH889

Price/Each \$

CORE BIT EXTENSION

- Extends Milwaukee core bits by 12"
- For core bits with 5/8"-11 threads
- Apply anti-seize lubricant to threads before use
- Shank Size: 5/8"
- Overall Length: 12"
- Max. Diameter: 5/8"

Model No. TCR609
Mfg. No. 48-17-6012
Price/Each \$



DIAMOND THREADED CORE BIT EXTENSION

- Designed for Milwaukee threaded core bits
- Apply anti-seize lubricant to threads before use
- Overall Length: 12"
- Thread Size: 1-1/4"-7

Model No. TCR739
Mfg. No. 48-17-6016
Price/Each \$

