

ATTENTION: TO ENSURE SAFE AND EASY USE OF YOUR WESCO LIFT TABLE, READ THESE INSTRUCTIONS BEFORE USING.

Description

The Wesco Lift Tables are designed for safe, easy, transportation and lifting of materials.

This product is distributed by:

Wesco Industrial Products, LLC
1250 Welsh Road
North Wales, PA 19454
Tel: 215-699-7031 Fax: 215-699-3836

Contact the factory for parts information and ordering.
Visit us on the web at www.wescomfg.com

Unpacking

When unpacking the Wesco Product, check carefully for shipping damage and missing parts. If damage has occurred or any parts are missing, file a claim with the delivering carrier within 24 hours and notify the dealer from whom the unit was purchased.

Warranty Repairs

If the unit does not work properly, contact your dealer or the factory (215-699-7031) for units less than one year.

Non-Warranty Service

If units are older than one year, repairs can be made easily on site with factory supplied parts.

NOTE: Do not send units to the factory for service without first obtaining a "Return Merchandise Authorization" (RMA) number from the customer service department. We will not be responsible for merchandise returned without proper authorization.

Specifications

Model #	Capacity	Raised Height	Table Size	Weight
LT-02-1616 P/N 260059	200 lbs	46"	16" x 16"	54 lbs
LT-05-1818 P/N 260060	500 lbs	47.5"	18" x 18"	122 lbs
LT-10-1836 P/N 260061	1,000 lbs	47.5"	18" x 36"	168 lbs
LTL-20-2436 P/N 260062	2,000 lbs	47.5"	24" x 36"	308 lbs
LTL-20-3248 P/N 260063	2,000 lbs	47.5"	32" x 48"	350 lbs

General Safety Information

Warning: The Wesco Lift Tables are designed for a wide range of uses. To ensure safe use, the following instructions must be adhered to.

- 1) **Load Rating:** The capacity of your unit is shown on a metal tag on the base of the table. Do not exceed load rating printed on metal tag. Always use caution when using unit at or near capacity.
Note: Make sure load is centered on table.
- 2) It is not recommended to use your unit for loads exceeding the size of the table.
- 3) Never move the unit unless the table is in the lower position.
- 4) Wesco Lift Tables are intended for movement of loads and lifting loads to a comfortable working position. The Lift Tables are not intended for positioning loads in a raised position for an extended period of time. Do not leave unit unattended with load in raised position.
- 5) If custom alterations, to the Lift Tables, are *not* made at the factory, Wesco will void all warranties. User made alterations may result in unsafe conditions during use of unit.
- 6) Wesco floor locks are designed to prevent movement of unit during loading and unloading. They are not to be used to control truck when being moved.
- 7) Do not use unit on inclines.
- 8) Inspect unit thoroughly daily before operating.
- 9) When unit is not in use, it should be completely lowered, and release valve should be closed.
- 10) Make sure that all attachments are completely tightened.
- 11) Do not operate a damaged unit until it is completely repaired.
- 12) Always remove load before repairing.

Operation Instructions

Hydraulic Lift Table is ready to use as shipped. If hydraulic jack does not operate properly, contact the dealer you purchased unit from immediately. To raise table, pump foot pedal up and down. To lower table, turn release rod counter-clockwise.

Warning: DO NOT ATTEMPT REPAIRS ON ANY NEW UNIT SHOULD FAILURE OCCUR. DOING SO WILL VOID THE WARRANTY.

To Purchase Parts

To Order Parts contact Customer Service at:
Phone: 215-699-7031
Fax: 215-699-3836

ATTENTION: TO ENSURE SAFE AND EASY USE OF YOUR WESCO LIFT TABLE, READ THESE INSTRUCTIONS BEFORE USING.

Parts List

Item	Part #	Model	Description	Qty
1	050740	LT-02-1616 LT-05-1818	Relief Handle	1
	050742	LT-10-1836 LTL-20-2436		
	050779	LTL-20-3248		
2	050734	LT-02-1616 LT-05-1818	Foot Pedal	1
	050739	LT-10-1836 LTL-20-2436		
	050777	LTL-20-3248		
3	051458	All	Identification Plate	1
4 & 5	052570 & 052571	LT-02-1616	Table Top & Table Base	1 & 1
	050970	LT-05-1818		1
	050971	LT-10-1836		
	050972	LTL-20-2436		
	050973	LTL-20-3248		
6	108602	All	Screw: Flat 5/16-18	2
7	108172	All	Nut: Lock 5/16-18	2
8	100168	LT-02-1616	Screw: Hex 1/4-20x1-1/4"	2
	101231	LT-05-1818 LT-10-1836 LTL-20-2436 LTL-20-3248	Bolt: Carriage 1/4-20x1"	4
9	108427	All	Washer: Flat 1/4"	4
10	150267	All	Nut: Keps 1/4-20	4
11	270260	LT-02-1616 LT-05-1818	Hydraulic Jack	1
	270259	LT-10-1836 LTL-20-2436		
	270271	LTL-20-3248		
12	150001	LT-05-1818 LT-10-1836 LTL-20-2436 LTL-20-3248	Floor Lock	1
13	055047	All	Plate	1
14	051397	LTL-20-2436 LTL-20-3248	Shim	2
15	100108	LT-02-1616	Screw: Socket 1/4-20x3/8	2

Model Figures



Figure 1
Model LT-02-1616



Figure 2
Model LT-05-1818

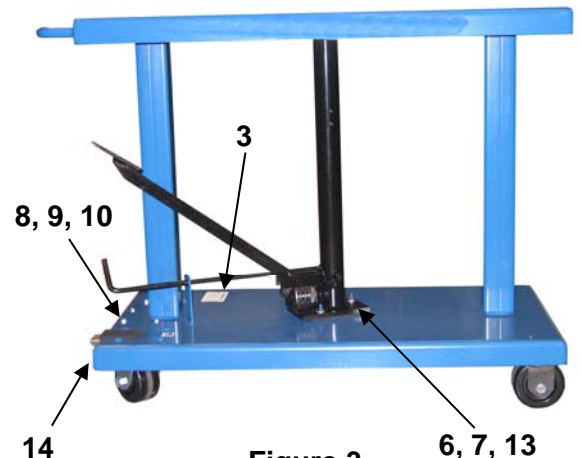

Figure 3
Model LT-10-1836

Note: Contact Customer Service for Factory Installed Options Replacement Parts

159082J

ATTENTION: TO ENSURE SAFE AND EASY USE OF YOUR WESCO LIFT TABLE, READ THESE INSTRUCTIONS BEFORE USING.

Jack Part Information

- NOTES:**
 (A) PARTS WITH (*) SHOWN COMPROMISE "SEAL KIT"
 (B) THREE BLOCKS MARKED "C" ARE SOLD ONLY AS ONE KIT: "PUMPING/RELEASE VALVE ASSEMBLY".
 (C) PARTS AVAILABLE ONLY IN ASSEMBLIES OR KITS SHOWN ON THIS DRAWING.

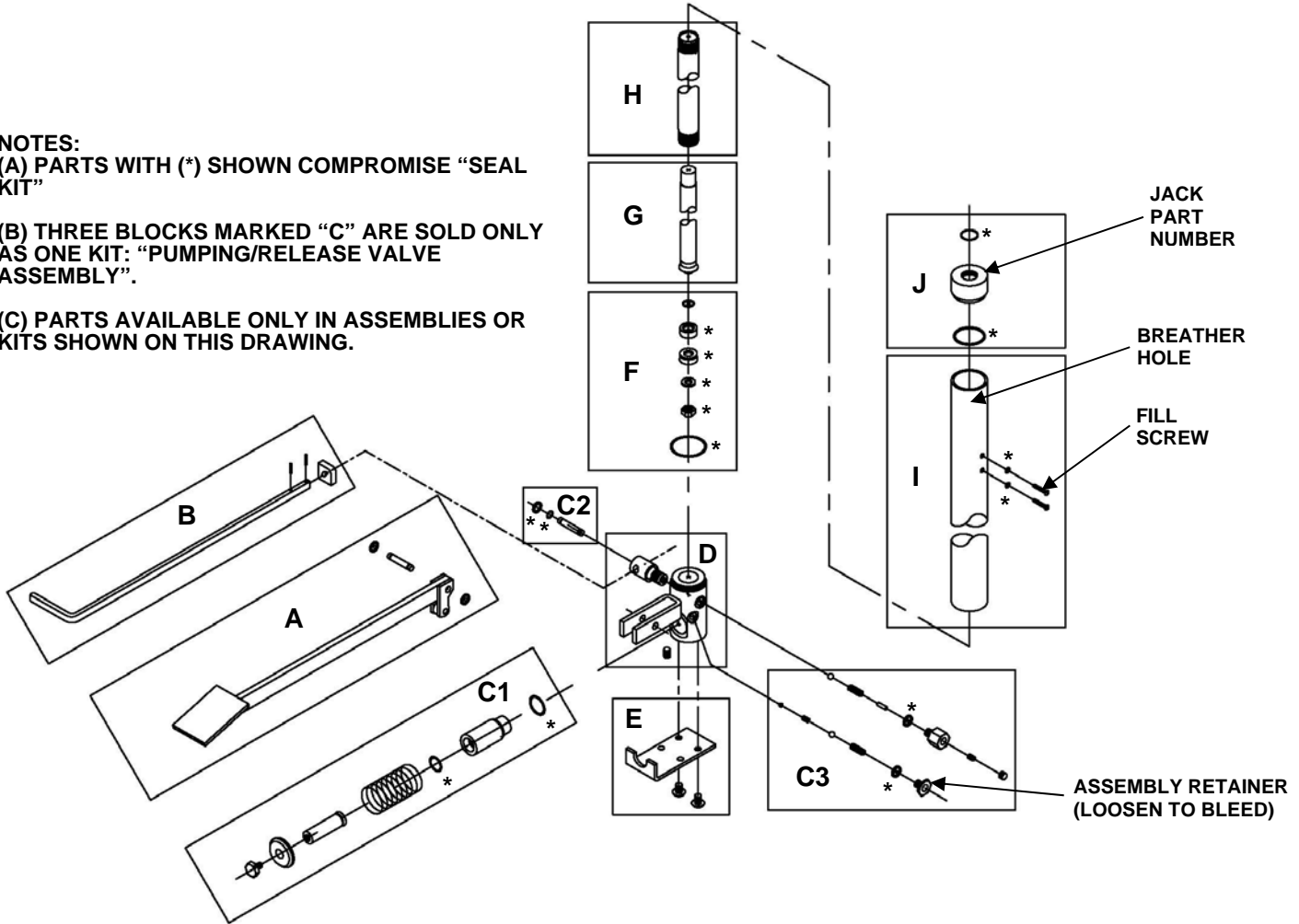

ITEM	DESCRIPTION	LT-02-1616	LT-05-1818	LT-10-1836	LTL-20-2436	LTL-20-3248
A	Pumping Pedal Assembly	050734	050734	050739	050739	050777
B	Relief Handle Assembly	050740	050740	050742	050742	050779
C	Pumping/Release Valve Assembly	050754	050754	050754	050754	050754
D	Jack Body	050733	050733	050733	050733	050733
E	Jack Base	050756	050756	050756	050756	050756
F	Main Piston Hardware	050767	050767	050767	050767	050767
G	Main Piston	051156	051156	051156	051156	051156
H	Inner Cylinder	051040	051040	051040	051040	051040
I	Outer Cylinder	051041	051041	051041	051041	051041
J	Outer Cylinder Hardware	050757	050757	050757	050757	050757
*	Seal Kit (See Star Items)	052722	052722	052722	052722	052722
	Complete Jack (Without Items A & B)	051167	051167	051167	051167	051167
	Complete Jack (With Items A & B)	270260	270260	270259	270259	270271



Lift Tables
(200 lbs, 500 lbs, 1,000 lbs LTs & 2,000 lbs LTLs Capacity)
Operating Instructions and Parts Manual

ATTENTION: TO ENSURE SAFE AND EASY USE OF YOUR WESCO LIFT TABLE, READ THESE INSTRUCTIONS BEFORE USING.

Limited Warranty

Wesco Industrial Products, LLC (WESCO) warrants to the purchaser of this product for a period of (1) year from the date of purchase that this product shall be free of defects in material and/or workmanship, as follows:

1. WESCO will supply, at no charge, new or rebuilt replacements for any part that fails through a defect in material and/or workmanship during the warranty period. To obtain warranty service, you must deliver the product prepaid, to the WESCO factory.
2. This warranty does not cover any product or product part which has been subject to accident, misuse, abuse or negligence. WESCO shall only be liable under this warranty if the product is used the manner intended by the manufacturer as specified in the written instructions furnished with this product.

REPAIR OR REPLACEMENT AS PROVIDED UNDER THIS WARRANTY IS THE EXCLUSIVE REMEDY OF THE PURCHASER. ANY EXPRESS WARRANTY NOT PROVIDED IN THIS WARRANTY DOCUMENT, AND ANY REMEDY FOR BREACH OF CONTRACT THAT, BUT FOR THIS PROVISION, MIGHT ARISE BY IMPLICATION OR OPERATION OF LAW, IS HEREBY EXCLUDED AND DISCLAIMED. UNDER NO CIRCUMSTANCES SHALL WESCO BE LIABLE TO PURCHASER OR ANY OTHER PERSON FOR ANY INCIDENTAL OR CONSEQUENTIAL DAMAGES, WHETHER ARISING OUT OF BREACH OF WARRANTY, EXPRESS OR IMPLIED, A BREACH OF CONTRACT OR OTHERWISE. EXCEPT TO THE EXTENT PROHIBITED BY APPLICABLE LAW, ANY IMPLIED WARRANTY OF MERCHANTABILITY AND FITNESS FOR ANY PARTICULAR PURPOSE ARE EXPRESSLY LIMITED IN DURATION TO THE DURATION OF THIS LIMITED WARRANTY.

Some states do not allow the exclusion or limitation of incidental or consequential damages, or allow limitations on how long any implied warranty lasts, so the above limitations may not apply to you. This warranty gives you specific legal rights, and you may also have other rights which vary from state to state.